

# ROPER ELEMENTARY



*Student Handbook & Calendar*

2323 S. Coddington Avenue | 402-436-1170 | Fax: 402-458-3270 | [Roper.LPS.org](http://Roper.LPS.org)

Lynn Fuller, Principal | [lfuller@LPS.org](mailto:lfuller@LPS.org)

**ROCKETING STUDENTS TOWARD SUCCESS!**



# Table of Contents

LPS Student Calendar .....	1
A Message from Principal Lynn Fuller .....	2
Roper School Improvement Goals .....	2
Staff Listing .....	3
Welcome to Roper Elementary School! .....	4
Intent of Student Handbook .....	4
How To Be A Super Improver... ..	4
August 2025 .....	5
Hello Roper Families! .....	6
September 2025 .....	7
Bus Transportation .....	8
Safety Practices To and From School .....	8
Arrival Plan .....	8
October 2025 .....	9
Dismissal Plan .....	10
Mental and Behavioral Health	
Point of Contact .....	10
November 2025 .....	11
Traffic Flow/Parking .....	12
Late Arrival/Early Dismissal .....	12

December 2025 .....	13
Important Information Needed .....	14
Absences .....	14
Releasing Students .....	14
Guidelines for the Dismissal of Students	
with Health Concerns .....	14
Medical and Dental Appointments	
on School Time .....	14
Dental Inspections .....	14
January 2026 .....	15
Attendance and School Schedule .....	16
Fire and Tornado Drills .....	16
The LPS Attendance Policy .....	16
February 2026 .....	17
Bullying .....	18
Language .....	18
Student Use of Telephone .....	18
Telephone Messages .....	18
March 2026 .....	19
Communicating Student Progress .....	20
LPS Parent Center .....	20
Communication Methods .....	20
April 2026 .....	21

Trips or Excursions .....	22
Optional 4th and 5th Grade	
Instrumental Music .....	22
ParentVue .....	22
School Messenger .....	22
Student Materials .....	22
Items From Home to School .....	22
Textbook and Material Fines .....	22
ELL (English Language Learners) .....	22
Recess Temperature Guidance .....	22
May 2026 .....	23
Before & After School Child Care for	
Roper Elementary School .....	24
Food, Presents, Parties .....	24
Fund-A-Need .....	24
June 2026 .....	25
2025-2026 Lunch Schedule .....	26
Meal Payment .....	26
Free/Reduced Lunch Applications .....	26
Lunch Time Visitors .....	26
July 2026 .....	27
Drop Off/Pick Up Traffic Maps .....	28

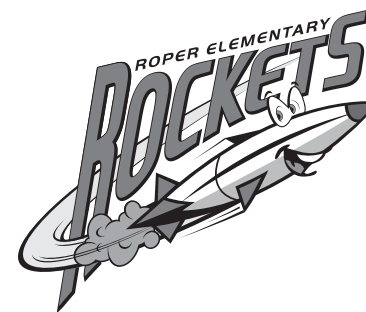

## Roper Elementary Mission Statement

### Rocketing Students Toward Success

Realizing potential

Opportunities for all

Parents, educators, children, community  
working together

Encouraging each other

Respecting differences

### For Bilingual Liaisons:

Arabic: 402-436-1715 نرجو الإتصال على هذه الأرقام إذا كنتم تحتاجون إلى خدمات الترجمة للغات العربية

Russian: Если вам требуются услуги переводчика пожалуйста позвоните по телефону: 402-436-1942

Español: Por favor llame a este número de teléfono si necesita servicios de intérpretes: 402-436-1938

Vietnamese: Xin vui lòng gọi về số này nếu quý vị cần có dịch vụ thông dịch: 402-436-1939

Ukrainian: Будь ласка, зателефонуйте за цим номером, якщо вам потрібні послуги перекладу: 402-436-1786

Karen: ဝံသးစူကီးလိတဲစိနိုဂ်အဲအံ့ပဲနမ္မာ်လိဂ်ဘုဂ်ပုကတိကျီးထံတဲအတဲအိဂ်ထွဲမၤစၢ 402-436-1769



### Please Note:

All procedures, guidelines and dates outlined in these documents are subject to change, based on recommendations and health directives put into place by the Lincoln Lancaster County Health Department (LLCHD) and the Nebraska Department of Education. Please keep in mind that, as with our Standard Response Protocols, every Lincoln Public Schools building or program which provides services may not always be in the same risk category.



# LPS Student Calendar



# 2025-26

## Graduation Dates

**Tuesday, May 19, 2026**

Yankee Hill

**Wednesday, May 20, 2026**

Independence Academy

**Thursday, May 21, 2026**

Bryan Community Focus Program

**At Pinnacle Bank Arena May 22-24, 2026**

**Fri:** LSE **Sat:** LNE, LSW, LNW, LNS **Sun:** EHS, LHS, LSB

☉ First Day for K, 6, & 9th Grades

☉ First Day for 1-5, 7-8, & 10-12th Grades

● Last Day for Students

■ All Schools Not in Session

▮ Schools Not in Session (*Professional Learning/Planning Day*)

➤ Quarter Start Dates

➤ Quarter End Dates

**Calendar Options for Families:** The Lincoln Public Schools District understands and appreciates that our community has a wide variety of rich and varied religious celebrations and observances. In the event families recognize these holidays, parents should notify schools. Students will be given excused absences and allowed reasonable opportunities to make up any schoolwork missed.

**Note:** Changes to the calendar may occur as a result of inclement weather or other circumstances. If sufficient school time is lost as a result of calendar changes, and it brings the total number of school hours for the year below the state minimum requirements, the Superintendent will implement a plan for making up this time, which may require additional minutes added to the day, additional days added to the calendar, days previously identified as non-student days re-scheduled as student day, or other appropriate calendar or schedule measures.

## JULY 2025

S	M	T	W	T	F	S
		1	2	3	4	5
6	7	8	9	10	11	12
13	14	15	16	17	18	19
20	21	22	23	24	25	26
27	28	29	30	31		

## AUGUST 2025

S	M	T	W	T	F	S
					1	2
3	4	5	6	7	8	9
10	11	12	13	14	15	16
17	18	19	20	21	22	23
24	25	26	27	28	29	30
31						

## SEPTEMBER 2025

S	M	T	W	T	F	S
	1	2	3	4	5	6
7	8	9	10	11	12	13
14	15	16	17	18	19	20
21	22	23	24	25	26	27
28	29	30				

## OCTOBER 2025

S	M	T	W	T	F	S
			1	2	3	4
5	6	7	8	9	10	11
12	13	14	15	16	17	18
19	20	21	22	23	24	25
26	27	28	29	30	31	

## NOVEMBER 2025

S	M	T	W	T	F	S
						1
2	3	4	5	6	7	8
9	10	11	12	13	14	15
16	17	18	19	20	21	22
23	24	25	26	27	28	29
30						

## DECEMBER 2025

S	M	T	W	T	F	S
	1	2	3	4	5	6
7	8	9	10	11	12	13
14	15	16	17	18	19	20
21	22	23	24	25	26	27
28	29	30	31			

## JANUARY 2026

S	M	T	W	T	F	S
				1	2	3
4	5	6	7	8	9	10
11	12	13	14	15	16	17
18	19	20	21	22	23	24
25	26	27	28	29	30	31

## FEBRUARY 2026

S	M	T	W	T	F	S
1	2	3	4	5	6	7
8	9	10	11	12	13	14
15	16	17	18	19	20	21
22	23	24	25	26	27	28

## MARCH 2026

S	M	T	W	T	F	S
1	2	3	4	5	6	7
8	9	10	11	12	13	14
15	16	17	18	19	20	21
22	23	24	25	26	27	28
29	30	31				

## APRIL 2026

S	M	T	W	T	F	S
			1	2	3	4
5	6	7	8	9	10	11
12	13	14	15	16	17	18
19	20	21	22	23	24	25
26	27	28	29	30		

## MAY 2026

S	M	T	W	T	F	S
					1	2
3	4	5	6	7	8	9
10	11	12	13	14	15	16
17	18	19	20	21	22	23
24	25	26	27	28	29	30
31						

## JUNE 2026

S	M	T	W	T	F	S
	1	2	3	4	5	6
7	8	9	10	11	12	13
14	15	16	17	18	19	20
21	22	23	24	25	26	27
28	29	30				

## A Message from Principal Lynn Fuller

It is a great privilege to be the Principal at Roper Elementary School. For more than twenty five years, Roper has been an important part of the West A Community. We appreciate the close relationship we have with the community and are continually humbled by your generosity and support.

The dedication of the staff at Roper is inspiring. Teachers care deeply for students and work hard to help them succeed. Our priority is on student learning, insuring every student is challenged to achieve or exceed grade level, district and state expectations. We accept no limits on the learning potential of any child.

At Roper, we provide a safe, orderly and respectful environment, which promotes high levels of student engagement. We honor the diversity and unique talents of all of our students, embracing the different cultures and backgrounds that represent our community.

We are excited to offer students daily experiences in art, computer science, library media, music, physical education and wellness. These enriching opportunities extend the learning that students are provided in the classroom and often inspire lifelong pursuits. This is just part of our commitment to serving your child's unique academic, behavioral, social and emotional needs.

We look forward to partnering with you in the year ahead. Working together, we can provide your child(ren) with exactly what they need to be successful this school year and for years to come. If you have questions about your child at any time, please don't hesitate to contact your student's teacher or myself at 402-436-1170.



Sincerely,

**Dr. Lynn Fuller, Principal**  
Roper Elementary School



## Roper School Improvement Goals

*Students at each grade level will demonstrate growth in Fluency and Number Sense, working to be on track for the next grade level.*

For the most up-to-date information log on to Roper website: [Roper.LPS.org](http://Roper.LPS.org)  
LPS web site: [LPS.org](http://LPS.org)

### Office Hours

7:30 a.m. – 4:15 p.m.  
Phone: 402-436-1170





# Staff Listing



## Office

Lynn Fuller, Principal .....lfuller@LPS.org  
Maggie Picou, Assistant Principal .....mpicou@LPS.org  
Jamie Thavenent, Sp Educ Coord. ....jthavene@LPS.org  
Rachel Schrunck, Secretary III .....rschrun@LPS.org  
Bailey Jones, Secretary II .....bjones7@LPS.org  
Deb Kendle, Secretary II .....dkendle@LPS.org  
Renee King, School Social Worker .....rking4@LPS.org  
Sidney Olson, School Counselor .....solson3@LPS.org  
Tristen Colclasure, School Counselor .....tcolclas@LPS.org  
Hosanna Sok, School Nurse .....hsok@LPS.org  
Michelle Ball, Health Technician .....mball2@LPS.org

## Specialists

Peggy Dynek, Media .....mdynek@LPS.org  
Jackie Haecker, Art .....jfousek@LPS.org  
Chelsea Mattox, PE .....crolofs@LPS.org  
Tyler Johnson, Wellness/Computer .....tjohnso7@LPS.org  
Caitlin Hoppe, Art .....choppe@LPS.org  
Julie Wilson, Music .....jwilson@LPS.org  
Shelly Jones, Gifted .....sjones4@LPS.org  
Megan Stump, Instrumental .....mstump@LPS.org  
Jessica Porter, Band .....jjensen9@LPS.org

## Kindergarten Teachers

Jerri Graham .....jschinc@LPS.org  
Katelynn Huskey .....khuskey@LPS.org  
Lisa Kistaitis .....lkistai@LPS.org  
Brittni Peters .....bpeters4@LPS.org  
Kathy Sechrest .....ksech@LPS.org

## First Grade Teachers

Becky Bricker .....bbricker@LPS.org  
Emma Gordon .....egordon@LPS.org  
Brooke Graves .....bgraves2@LPS.org

Colbi Larkins .....clarkins@LPS.org  
Robyn Robinson .....rrobins@LPS.org  
Cindy Williams .....llwillia1@LPS.org

## Second Grade Teachers

Chloe Bowman .....cbowman2@LPS.org  
Corinne Michael .....cmichael@LPS.org  
Brooke Smith .....bsmit11@LPS.org  
Karli Suarez .....ksuarez@LPS.org  
Lacey West .....lwest2@LPS.org

## Third Grade Teachers

Darcy Bearinger .....dbearing@LPS.org  
Sarah Carlson .....sberry@LPS.org  
Nikky French .....nfrench@LPS.org  
Alejandro Gonzalez .....agonzale@LPS.org  
Lacey Lane .....llane@LPS.org  
Linda McKeen .....lmkeen@LPS.org  
Kelsie Ronspies .....kronspie@LPS.org

## Fourth Grade Teachers

Jerry Dittenber .....jditten2@LPS.org  
Christine Genrich .....cmckinn@LPS.org  
Tori Hupf .....thupf@LPS.org  
Tiffany Patrick .....tpatric@LPS.org  
Alexys Pryor .....lpryor2@LPS.org

## Fifth Grade Teachers

Sarah Cooper .....scooper4@LPS.org  
Jamie Cooper .....jcooper4@LPS.org  
Tracy Kastl .....tkastl3@LPS.org  
Rebecca Schrock .....rschrock@LPS.org  
Linda Scott .....scott3@LPS.org  
Grace Smith .....gsmith4@LPS.org  
Samone Tate .....state@LPS.org

## Special Education Teachers

Mary Boyle .....mboyle@LPS.org  
Megan Danielson .....mdaniel@LPS.org  
Kim Gruber .....kgruber@LPS.org  
Amanda Mason .....amason2@LPS.org  
Hannah Phillips .....hphillip@LPS.org  
Kati Prokop .....kwobig2@LPS.org  
Hayley Schell .....hschell@LPS.org

## Speech/Language Pathologists

Karen Linderman .....klinder@LPS.org  
Brooke Stohs .....bstohs@LPS.org

## ELL Teachers

Pam Piechota .....ppiech@LPS.org  
Ann Schmer .....aschmer@LPS.org  
Amber Sterns .....asterns@LPS.org  
Morgan Weis .....mweis@LPS.org

## Intervention

Kelly Dodd .....kdodd@LPS.org  
Kelli Joe .....kjoe@LPS.org  
Krista Van Pelt .....kvanpel@LPS.org  
Jessica Voelker .....jvoelker@LPS.org

## Preschool/Early Childhood Teacher

Tiffany Claycomb .....tclaycom@LPS.org  
Pam Harrell (AM) .....pharrell@LPS.org  
Sydney Girmus (ECSE) .....sgirmus@LPS.org  
Linda Gregory (PM) .....lgregory@LPS.org  
Mariah Miller (AM) .....mmille19@LPS.org  
Taylor Tiefenthaler (PM) .....ttiefent@LPS.org

# Welcome to Roper Elementary School!

Our priority at Roper is to focus on student learning, ensuring every student is challenged to achieve or exceed grade level district and state expectations. We accept no limits on the learning potential of any child. Roper is organized into grade level instructional teams: Preschool through fifth grade. Staff works closely with parents, as we know that a strong parent, school relationship is critical to ensure student success.

## Intent of Student Handbook

This handbook is intended for students, parents, and staff as a guide to the rules, regulations, and general information about Roper Elementary. Each family is responsible for becoming familiar with the handbook and knowing the information contained within.

This handbook does not create a “contract”. The administration reserves the right to make decisions and rule revisions at any time to implement the educational program and to assure the well being of all students. The administration will be responsible for interpreting the rules contained in the handbook. Should the situation or circumstances arise that is not specifically covered in this handbook, the administration will make a decision based upon all applicable school district policies, and state and federal statutes and regulations.



## How To Be A Super Improver...

Your child might talk about being a Super Improver! This positive, student-centered approach helps motivate and celebrate individual growth. Super Improver challenges each student to become better, stronger, and faster than ever before on something they are personally working toward – whether it’s improving their writing, showing kindness, staying on task, or mastering math facts.

Each student begins on the “Mission Ready” level and earns stars for showing consistent effort and improvement in a specific area. As they collect stars, they level up, promoting a sense of achievement and pride in their growth. It’s not about being perfect – it’s about making progress!

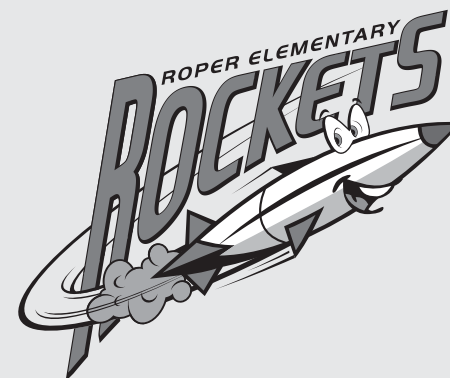

# August 2025

## Lincoln Public Schools

SUNDAY	MONDAY	TUESDAY	WEDNESDAY	THURSDAY	FRIDAY	SATURDAY
					1	2
3	4	5	6	7 Open House/ Safe Ride to School at 5:00 pm	8	9
10	11	12 First Day for K, 6, and 9th Grades	13 First Day for 1-5, 7-8 and 10-12th Grades	14	15 First Day of Preschool	16
17	18	19	20	21	22	23
24	25	26	27 Picture Day	28 PTO Quarter Meeting at 3:15pm	29	30
31						

## » Important Dates

**August 7th**  
Open House/ Safe Ride to School at 5:00 p.m.

**August 12th**  
First Day for K, 6, and 9th Grades

**August 13th**  
First Day for 1-5, 7-8, and 10-12th Grades

**August 15th**  
First Day of Preschool

**August 27th**  
Picture Day

**August 28th**  
PTO Quarter Meeting at 3:15p.m.

*All procedures, guidelines and dates outlined in this document are subject to change, based on recommendations and directives issued by the Nebraska Department of Education, the Lincoln Lancaster County Health Department (LLCHD), or other governing body.*

# Hello Roper Families!

A big welcome back to our returning families—and a warm welcome to those who are new to our community! The Roper Elementary PTO is excited for a successful 2025–2026 school year.

Our mission is to support school staff in creating a safe, fun, and engaging learning environment where all students can thrive. Throughout the year, the PTO sponsors a variety of events and activities, including:

- Afterschool Clubs
- Summer Feeding Program
- Support for the school library
- Care Closets
- Classroom hydroponic program
- Teacher appreciation (conference meals, Teacher Appreciation week)
- Fun social events (Valentines Event, Color Run, Blast off)
- Educational materials for students
- ...and much more!

This year, we're excited to embark on a transformative project to redesign our school courtyard into a dynamic and inclusive outdoor classroom space. Our vision is to create an environment that enhances learning, stimulates the senses, and fosters a deeper connection with nature.

Highlights of the new courtyard will include:

- **New Plantings:** A variety of student-friendly plants to create a lush, inviting environment.
- **Sensory Area:** Designed to engage all five senses, this space will include textured plants, fragrant plants, and more.
- **Seating Area:** To accommodate classes of all sizes and learning styles.
- **Musical Instruments:** Outdoor instruments that allow students to explore sound and rhythm in a natural setting.

Through this project, we aim to create a space where students from all classes can learn, explore, and thrive outside the traditional classroom

walls. Along with the courtyard transformation we are working on a Prairie Area this will be a dedicated section of the Roper grounds that will showcase native plants and attract butterflies, providing a living laboratory for ecological studies and nature appreciation.

## We Need Your Help!

The PTO is powered by parents, and we can't do it without the support of our Roper families. Every family brings something unique—whether it's time, talent, or ideas. That's why we offer many different ways to get involved throughout the year.

## Get involved today!

Stay up to date and connected:

- Join us on PTBoard: [roper.ptboard.com](http://roper.ptboard.com) or scan the QR code:
- Follow us on Facebook: Roper PTO
- Email us anytime at [roperpto@gmail.com](mailto:roperpto@gmail.com)
- Color Run Celebration September 20, 10:00 a.m.
- Spring Fundraiser March 16th - 30th



## Don't forget our quarterly public PTO meetings—your voice matters!

### Join Our Parent Meeting

Time: 3:15–4:15 P.m.

Location: East Library

Child care and snacks provided!

- August 28
- November 13
- January 15
- April 9

We're looking forward to working together and making this an amazing year for our kids!



# September 2025

## Lincoln Public Schools

SUNDAY	MONDAY	TUESDAY	WEDNESDAY	THURSDAY	FRIDAY	SATURDAY
	1	2	3	4 Cattle Bank	5	6
	SCHOOLS CLOSED	SCHOOLS CLOSED				
7	8	9	10	11 Cattle Bank	12	13
14	15	16	17	18 Cattle Bank	19	20
21	22	23	24	25 Cattle Bank	26	27
28	29	30				

## » Important Dates

**September 1st-2nd**  
Schools Closed

**September 4th**  
Cattle Bank

**September 11th**  
Cattle Bank

**September 18th**  
Cattle Bank

**September 25th**  
Cattle Bank

*All procedures, guidelines and dates outlined in this document are subject to change, based on recommendations and directives issued by the Nebraska Department of Education, the Lincoln Lancaster County Health Department (LLCHD), or other governing body.*

## Bus Transportation

Lincoln Public Schools provides limited bussing based on student needs. Bus service is a privilege. Students are expected to maintain good behavior and follow safety rules at all times on the bus. If you have questions about qualifying for bus eligibility, please ask one of the administrators listed below.

- Students are to walk to their assigned grade level waiting area or breakfast upon arrival. Teachers will meet them there.
- Some students will be escorted from the bus to their classrooms.
- At the end of the day, students will be escorted to their bus by teachers.
- If a student will not be riding the bus home, they must have a signed note from parents/guardians.

## Safety Practices To and From School

In order to provide safety for walkers and riders, the following rules need to be followed. Parents are encouraged to plan with their children the shortest and safest route to school.

- Students should cross streets using the proper crosswalks as indicated by double white lines on the pavement.
- Parents should instruct their children to cross at corners or areas where school crossing signs are erected.
- Parents may park on the north side of the crosswalk or south of the drop-off zone in the Coddington traffic loop to walk students into the building.
- The parking lot is not a place for students to walk.

## Arrival Plan

### ARRIVAL PROCEDURES

- The Roper Elementary School campus is closed until 7:45 a.m.
- Students arriving for breakfast should not arrive before 7:45 a.m., as there is no supervision until that time.

### ARRIVAL

7:45 Breakfast—Enter through Door 1 – east

7:55 Supervision will be provided at designated entry doors (if there is inclement weather, students will enter the designated door and wait inside). Students arriving prior to 7:55 must enter through Door 1 for breakfast.

#### Entry Doors

- Kindergarten - Door 25 and 26
- 1st Grade - Door 2
- 2nd Grade - Door 6
- 3rd Grade - Door 3 and 9
- 4th Grade - Door 17 (inside)
- 5th Grade - Door 16

8:10 School Begins. Students meet teachers at designated entry doors.

8:15 – Tardy Bell

- Students will enter their arrival door if it is raining, snowing or the temperature is below 20.

### TEMPERATURE GUIDANCE - ARRIVAL

<20\* Students wait inside the arrival doors starting at 7:55. Willard will keep their students until 8:00 and will walk them through the building to get to their arrival areas.

Reminder - students arriving before 7:55 need to go to breakfast through Door 1. That is the only place where we have supervision at that time.



#### PARKING OR WAITING

Please do not force children into an unsafe situation. Park at the curb before loading or unloading children, NO double parking.

# October 2025

## Lincoln Public Schools

SUNDAY	MONDAY	TUESDAY	WEDNESDAY	THURSDAY	FRIDAY	SATURDAY
			1	2 Cattle Bank	3	4
5	6	7	8	9 Cattle Bank	10 Last day of Q1	11
12	13 SCHOOLS CLOSED	14 SCHOOLS CLOSED	15 First Day of Q2	16 Cattle Bank	17 Picture Retakes	18
19	20	21	22	23 Cattle Bank	24	25
26	27	28	29	30 Cattle Bank	31	

## » Important Dates

**October 2nd**  
Cattle Bank

**October 9th**  
Cattle Bank

**October 10th**  
Last day of Q1

**October 13th-14th**  
Schools Closed

**October 15th**  
First Day of Q2

**October 16th**  
Cattle Bank

**October 17th**  
Picture Retakes

**October 23rd**  
Cattle Bank

**October 30th**  
Cattle Bank

All procedures, guidelines and dates outlined in this document are subject to change, based on recommendations and directives issued by the Nebraska Department of Education, the Lincoln Lancaster County Health Department (LLCHD), or other governing body.

# Dismissal Plan

## DISMISSAL PROCEDURES

All students are dismissed from the building at 2:53 p.m.

- All students must go directly home or to a school sanctioned after school activity.
- Teachers will escort students out their designated exit door.
- School Campus (including the playground) is closed until 4:30 p.m. except for use by school childcare and clubs. Reservations for rooms/playground should be entered in the district Archibus system.

## DISMISSAL

2:53 - Students are learning in classrooms until the bell rings. Clean up begins at the bell. Students will be escorted outside by a teacher. All students must go directly home,

to daycare, or an on-site afterschool program. Our campus is closed after dismissal until 4:30 p.m., including the playground, except for use with school related activities or the Willard Community Center's School's Out program.

### Dismissal Doors

- Kindergarten – Door 25 and 26
- 1st Grade – Door 2
- 2nd Grade – Door 6
- 3rd Grade – Door 3 and 9
- 4th Grade – Door 17
- 5th Grade – Door 16
- Students attending Willard after school program will be picked up inside the building by Willard staff.
- Students going to daycare or riding LPS transportation will be escorted through the building to Door 25 (east office) in

time for daycare or LPS transportation to leave the building BY 2:53.

- Students in 1st-3rd Grades who are walking home will exit out the door they enter at arrival. Typically they meet siblings by the bike rack at the north end of the Coddington Loop.
- Students should be picked up no later than 3:15. At this time, students will be escorted to the office. Parents/guardians will need to come in to the Main Office (Door 1) to pick up students. You will be asked to sign them out.
- In the event that students are not picked up by 3:30 p.m., and the office is unable to contact a parent or another adult listed as an emergency contact, for your safety, and the safety of your children, the police may be notified.



## Mental and Behavioral Health Point of Contact

Your student's mental health is important to their academic success. If you have concerns about your student's mental or behavioral health, you can contact the social worker at your student's school/program. LPS social workers are licensed mental health practitioners and can help connect you to appropriate mental health or behavioral supports. Go to [home.LPS.org/socialworkers/mental-behavioral-health-points-of-contact](https://home.LPS.org/socialworkers/mental-behavioral-health-points-of-contact) or scan the QR code for more information.





# November 2025

## Lincoln Public Schools

SUNDAY	MONDAY	TUESDAY	WEDNESDAY	THURSDAY	FRIDAY	SATURDAY
						1
2	3	4 Parent Teacher Conferences	5	6 Cattle Bank Parent Teacher Conferences	7	8
9	10	11	12	13 Cattle Bank PTO Quarterly Mtg at 3:15 pm	14	15
16	17	18	19 4th Grade - Cunningham One-Room Schoolhouse	20 Cattle Bank 4th Grade - Cunningham One-Room Schoolhouse	21 4th Grade - Cunningham One-Room Schoolhouse	22
23	24 4th Grade - Cunningham One-Room Schoolhouse	25 4th Grade - Cunningham One-Room Schoolhouse	26	27	28	29
30			SCHOOLS CLOSED	SCHOOLS CLOSED	SCHOOLS CLOSED	

## » Important Dates

**November 4th**  
Parent Teacher Conferences

**November 6th**  
Cattle Bank  
Parent Teacher Conferences

**November 13th**  
Cattle Bank  
PTO Quarterly Meeting at 3:15 p.m.

**November 19th-25th**  
4th Grade - Cunningham One-Room Schoolhouse

**November 20th**  
Cattle Bank

**November 26th-28th**  
Schools Closed

All procedures, guidelines and dates outlined in this document are subject to change, based on recommendations and directives issued by the Nebraska Department of Education, the Lincoln Lancaster County Health Department (LLCHD), or other governing body.

## Traffic Flow/Parking

Parents are asked to show extra caution in and around the school when dropping-off or picking up a child. Finding a parking space at Roper during the busy arrival and dismissal times can be difficult. Please follow these directives to alleviate traffic congestion at these busy times:

- Utilize the designated traffic loop for your child's grade level.
- Consider drop-off or pick-up points away from Roper in surrounding neighborhoods. The crosswalk to the east of Roper's main entrance will be supervised during busy arrival and dismissal times. If you choose to park in the neighborhood to walk your child to the school, please be courteous to our neighbors. Do not block driveways or mailboxes.
- If you choose to park in the school's parking lot, please do not block cars that are parked in parking stalls and leave your vehicle. Once you find a legal place to park, please walk your child to the building for their safety.



- Do not double-park in the loops. Do not encourage students to pass between cars when being picked up or dropped off. Always pull over to the curb before allowing your child out of the car. In a designated student loading zone.
- Do not park in a handicap parking space unless you have a registered parking permit or license plate. Always follow parking and traffic laws.

Together we can make student drop-off and pick-up safe and efficient.

## Late Arrival/Early Dismissal

Students who arrive any time after 8:10 a.m. must use Door #1. Door 16 will be locked after 8:10 a.m. All visitors will need to come through Door 1 once the school day has started.

Students who leave before the end of the day will need to be signed out by a parent or guardian.

- Parents are asked to walk up to the building to pick up their child.
- Students will be called to the office upon parent arrival at door 1. Our priority is to provide the maximum classroom time with minimum disruptions. It is not possible to know exactly when parents will arrive to pick students up for appointments. Please plan accordingly.
- For safety reasons, please do not ask for your child to wait outside to be picked up early.
- We will only release children to adults that have been designated by parents or guardians. If someone other than a parent or guardian will pick up your child, please provide something in writing to the school office or call the office to provide the name of the person picking the child up.
- If someone other than a parent or guardian is picking a child up, even with written notice or a phone call from the parent or guardian, they may be asked for identification. Please ask them to be patient as this is only for the safety of the student.
- Please note that before 8:30 and after 2:30 are busy times in the office. It would be best to call between the hours of 8:30 and 2:30 to notify the office of an appointment.

If there is a special circumstance, such as a court order limiting access to a student by a parent or guardian, the office must be informed and provided with a copy of the order to maintain on file at the school.

# December 2025

## Lincoln Public Schools

SUNDAY	MONDAY	TUESDAY	WEDNESDAY	THURSDAY	FRIDAY	SATURDAY
	1 SCHOOLS CLOSED	2 Strings Concert at 6:00 pm	3	4 Cattle Bank Chorus Concert at 6:00 pm	5	6
7	8	9	10	11 Cattle Bank	12	13
14	15	16	17	18 Cattle Bank	19 Last Day of Q2	20
21	22 SCHOOLS CLOSED WINTER BREAK	23 SCHOOLS CLOSED WINTER BREAK	24 SCHOOLS CLOSED WINTER BREAK	25 SCHOOLS CLOSED WINTER BREAK	26 SCHOOLS CLOSED WINTER BREAK	27
28	29 SCHOOLS CLOSED WINTER BREAK	30 SCHOOLS CLOSED WINTER BREAK	31 SCHOOLS CLOSED WINTER BREAK			

## » Important Dates

**December 1st**  
Schools Closed

**December 2nd**  
Strings Concert at 6:00 p.m.

**December 4th**  
Cattle Bank  
Chorus Concert at 6:00 p.m.

**December 11th**  
Cattle Bank

**December 18th**  
Cattle Bank

**December 19th**  
Last Day of Q2

**December 22nd-31st**  
Schools Closed

All procedures, guidelines and dates outlined in this document are subject to change, based on recommendations and directives issued by the Nebraska Department of Education, the Lincoln Lancaster County Health Department (LLCHD), or other governing body.



## Important Information Needed

For the safety of your child, it is necessary to give the school the name of a person to contact in case you cannot be reached. Please note: Persons listed as emergency contacts will be called to verify a student's absence if a parent/guardian cannot be reached.

It is very important that parents/guardian notify the school of any change in address and/or telephone number. The office must have a current telephone number on file in case we need to contact you for any emergency that could arise.

## Absences

In the event of a student absence, please call our school office at 402-436-1170 or enter the absence on ParentVue (before 8:10). This not only helps us know who will be part of our learning community for the day, but also serves as an extra safety precaution for you and your child. A parent will be called if a student is counted absent by the classroom teacher and an absence has not been called in by a parent or guardian. Absences can also be submitted on the ParentVue Portal.

## Releasing Students

For the safety of students, parents/guardians must come to the Security Entrance Monitor's desk at door 1 when picking up their child before the regular dismissal time. Office staff will contact the classroom teacher and the student will be sent to the Security Entrance Monitor's desk after parents/guardians have arrived. If someone other than a parent or guardian will pick up your child, please call the office to provide the name of the person picking up your child. If this office does not receive a phone call, we will need to reach out to the parent or guardian before releasing the student.

## Guidelines for the Dismissal of Students with Health Concerns

- The student with a temperature of 100 degrees or more
- The student with an undiagnosed rash. (Exception: If the student is taken to a physician, he/she may be readmitted with the doctor's written permission stating the rash is not contagious.)
- Other conditions, which may warrant a student being sent home, include: inflamed red eyes and/or drainage, vomiting and/or diarrhea, frequent persistent coughs, earache and/or drainage from the ear, questionable illness or injuries which may require evaluation by a physician, sores that appear infected or are draining, and any other possible communicable condition.

**No Student will be sent home until a parent or emergency contact has been notified.**

## Medical and Dental Appointments on School Time

Students are granted approved absences from school in order to keep medical and dental appointments during school hours. However, with Roper's early dismissal we encourage these appointments be made after school hours.

## Dental Inspections

Dentists recommended by the Lincoln District Dental Society and approved by the board of education perform dental inspections in the school. Students presenting a dental report form signed by their own dentist will be excused from the annual dental inspection.



# January 2026

## Lincoln Public Schools

SUNDAY	MONDAY	TUESDAY	WEDNESDAY	THURSDAY	FRIDAY	SATURDAY
				1	2	3
				SCHOOLS CLOSED WINTER BREAK	SCHOOLS CLOSED WINTER BREAK	
4	5 First Day of Q3	6	7	8 Cattle Bank	9	10
11	12	13	14	15 Cattle Bank PTO Quarterly Mtg at 3:15 pm	16	17
18	19 SCHOOLS CLOSED	20	21	22 Cattle Bank	23	24
25	26	27 Parent Teacher Conferences	28	29 Cattle Bank Parent Teacher Conferences	30	31

## » Important Dates

**January 1st-2nd**  
Schools Closed

**January 5th**  
First Day of Q3

**January 8th**  
Cattle Bank

**January 15th**  
Cattle Bank  
PTO Quarterly Meeting  
at 3:15 p.m.

**January 19th**  
Schools Closed

**January 22nd**  
Cattle Bank

**January 27th**  
Parent Teacher Conferences

**January 29th**  
Cattle Bank  
Parent Teacher Conferences

All procedures, guidelines and dates outlined in this document are subject to change, based on recommendations and directives issued by the Nebraska Department of Education, the Lincoln Lancaster County Health Department (LLCHD), or other governing body.

## Attendance and School Schedule

It is important to a student's success in school that the habit of regular and punctual attendance be formed. Please do not send your child to school if he/she is ill. The health of our children is important. We also understand that family emergencies may occur and families may need to be out of town.

Please remember to contact the office when your child is not going to be at school i.e. vacation plans, illness, appointments. This information is for attendance purposes. Even if you have informed the teacher you will still need to contact the office.

### PHONE NUMBER: 402-436-1170

An answering machine is provided for your 24-hour convenience. If a student cannot be accounted for, a phone call from office staff to the parent/guardian will occur.

**Please Note:** *Persons listed as emergency contacts will be called to verify a student's absence if a parent/guardian cannot be reached. Truancies will be subject to disciplinary action at the discretion of the principal.*

## Security Procedures

- **Secure** is implemented when there is a threat or hazard outside of the building.
- **Lockdown** is called when there is a threat or hazard inside the school building.
- **Hold** is used when we need to keep the hallways clear.
- **Evacuate** is an action we use for fire drills. It could be used for other situations that may warrant an evacuation.
- **Shelter** is used in response to severe weather. It may also be used for other environmental incidents.



## The LPS Attendance Policy

**It is required that schools notify parents of their child's absences at various intervals.**

- A letter will be sent home if a student has missed 10 school days.
- A letter will be sent home when a student has missed 15 or more days of school.
- If a student misses more than 20 days of school, a Stage 3 letter will be sent home.

Based on School Board Policy (Reg.5140.1), the school may report to the county attorney when a collaborative plan involving the school, guardian, and student to reduce barriers to improve regular attendance has not been successful, and the student has accumulated more than twenty (20) absences per year. Absence codes that make up the excessive absences include:

- IL - Illness
- PA - Parent Acknowledged
- TR - Truant

## Fire and Tornado Drills

The school has a plan to provide for the safety of each student in the event of a fire or tornado. Drills are held periodically during the year to insure speed and efficiency in getting the students to the assigned places of safety.

# February 2026

## Lincoln Public Schools

SUNDAY	MONDAY	TUESDAY	WEDNESDAY	THURSDAY	FRIDAY	SATURDAY
1	2	3	4	5 Cattle Bank	6	7
8	9	10	11	12 Cattle Bank	13	14
15	16 SCHOOLS CLOSED	17 SCHOOLS CLOSED	18	19 Cattle Bank	20	21
22	23	24	25	26 Cattle Bank	27	28

## » Important Dates

**February 5th**  
Cattle Bank

**February 12th**  
Cattle Bank

**February 16th-17th**  
Schools Closed

**February 19th**  
Cattle Bank

**February 26th**  
Cattle Bank

*All procedures, guidelines and dates outlined in this document are subject to change, based on recommendations and directives issued by the Nebraska Department of Education, the Lincoln Lancaster County Health Department (LLCHD), or other governing body.*



## Bullying

If you feel your child is being bullied by peers, please contact your child's teacher or the building principal, Lynn Fuller. All reported incidences of bullying/unsafe behavior will follow the protocol outlined in Lincoln Public Schools Board Policy 5482: Anti-Bullying Policy.

Bullying is unwanted, aggressive behavior among school aged children that involves a real or perceived power imbalance. The behavior is repeated, or has the potential to be repeated, over time.

In order to be considered bullying, the behavior must include:

- Imbalance of Power: Kids who bully use their power—such as physical strength, access to embarrassing information, or popularity—to control or harm others. Power imbalances can change over time and in different situations, even if they involve the same people.
- Repetition: Bullying behaviors happen more than once or have the potential to happen more than once.
- Hurtful aggressive physical and/or verbal behavior.
- Bullying includes actions such as making threats, spreading rumors, attacking someone physically or verbally, and excluding someone from a group on purpose.

As an added prevention piece, please discuss with your child adults in the building who they can talk to if they feel they are being bullied or are in an unsafe situation. These people may include, but are not limited to, their teacher, an administrator, school counselor, school psychologist, school social worker or any other adult in the building that they have built a positive relationship with.

Students are taught about what bullying looks like and sounds like, along with how to advocate for themselves through the District's Second Step program.

## Language

Students at Roper Elementary are expected to show respect to one another. Disciplinary action will be taken if a student uses inappropriate language at school.

## Student Use of Telephone

**Students are discouraged from bringing cell phones to school. Cell phones seen or heard can be considered nuisance items and confiscated.**

Students may use the telephone in either office in case of an emergency or to communicate important information as determined by the office staff or the principal. Students will not be allowed to use the phone to arrange afterschool play dates or to change afterschool plans without permission to do so.

## Telephone Messages

Telephone messages for your child will be relayed to your child only if an emergency exists. Classroom instruction is a priority. Parents needing to speak with their child's teacher may leave a message.





# March 2026

## Lincoln Public Schools

SUNDAY	MONDAY	TUESDAY	WEDNESDAY	THURSDAY	FRIDAY	SATURDAY
1	2	3	4	5 Cattle Bank	6 Last Day of Q3	7
8	9	10	11	12	13	14
	SCHOOLS CLOSED	SCHOOLS CLOSED	SCHOOLS CLOSED	SCHOOLS CLOSED	SCHOOLS CLOSED	
15	16 First Day of Q4	17	18	19 Cattle Bank	20	21
22	23	24	25	26 Cattle Bank	27	28
29	30	31				

## » Important Dates

**March 5th**  
Cattle Bank

**March 6th**  
Last Day of Q3

**March 9th-13th**  
Schools Closed

**March 16th**  
First Day of Q4

**March 19th**  
Cattle Bank

**March 26th**  
Cattle Bank

All procedures, guidelines and dates outlined in this document are subject to change, based on recommendations and directives issued by the Nebraska Department of Education, the Lincoln Lancaster County Health Department (LLCHD), or other governing body.



## LPS Parent Center

Welcome to the Lincoln Public Schools Parent Center.  
Check it out!

[www.LPS.org/parents](http://www.LPS.org/parents)

This selection of information is designed to meet the needs of LPS families, providing current information about services, resources, data and news of interest to parents.

## Communicating Student Progress

Lincoln Board of Education states (Policy 6570) that “student progress will be reported formally to parents/guardians at least four times each year.” Information about elementary student progress is reported in four areas.

1. Progress through district curriculum objectives
2. Performance in assigned curriculum level
3. Effort
4. Use of effective learning or study skills

Parent-Teacher conferences are scheduled twice a year. Please consult the Roper School Calendar for Parent-Teacher conference dates. Parents with immediate questions about their child’s academic progress are encouraged to contact the teacher at any time

## Communication Methods

### Weekly Communication Folders

Typically, school news will be sent home electronically on Thursdays. Some items will be sent home via paper copies in the Thursday Folder. Please return the folder the next day including any notes to your child’s teacher. General information will be sent with the oldest child in the family Attending Roper Elementary School.

### Community News

“Community News” is a newspaper distributed by Lincoln Public Schools, free to all elementary students the first week of every month from September through May. “Community News” replaces most informational flyers and can be used as a guide to community activities for students. The monthly school lunch menu is included in each issue of “Community News.”

### School Website

Information is regularly updated on our website: [Roper.LPS.org](http://Roper.LPS.org)

### ParentVue

Parents may access communications, attendance information and more for their child through ParentVue. A “button” linking you to ParentVue can be found on our school website.

### School Messenger

This district-wide communication system sends school and district emails, texts, and phone calls to families with important information. Please be sure the school has your updated phone number and email address.

### Facebook

Check out school happenings on our Facebook Page! “Like” us at Roper Elementary School

# April 2026

## Lincoln Public Schools

SUNDAY	MONDAY	TUESDAY	WEDNESDAY	THURSDAY	FRIDAY	SATURDAY
			1	2 Cattle Bank	3	4
					SCHOOLS CLOSED	
5	6 SCHOOLS CLOSED	7	8	9 Cattle Bank PTO Quarterly Mtg at 3:15 pm	10	11
12	13	14	15	16 Cattle Bank	17	18
19	20	21 Chorus Concert at 6:00 pm	22	23 Cattle Bank	24	25
26	27	28 Strings Concert at 6:00 pm	29	30 Cattle Bank		

## » Important Dates

**April 2nd**  
Cattle Bank

**April 3rd**  
Schools Closed

**April 6th**  
Schools Closed

**April 9th**  
Cattle Bank  
PTO Quarterly Meeting at 3:15 p.m.

**April 16th**  
Cattle Bank

**April 21st**  
Chorus Concert at 6:00 p.m.

**April 23rd**  
Cattle Bank

**April 28th**  
Strings Concert at 6:00 p.m.

**April 30th**  
Cattle Bank

All procedures, guidelines and dates outlined in this document are subject to change, based on recommendations and directives issued by the Nebraska Department of Education, the Lincoln Lancaster County Health Department (LLCHD), or other governing body.

## Trips or Excursions

All students will be transported by bus or walk if a field trip is in the surrounding neighborhood. A field trip parent/guardian approval form is located on the back of the census form. Each student will receive a census form in the LPS Important Information Packet before school starts. This form will need to be signed and returned the first day of school.

## Optional 4th and 5th Grade Instrumental Music

Students who enroll will receive a 30 minute lesson on their instrument once a week during school hours. There will also be a rehearsal after school from 3:00 to 3:50 once a week. Attendance at lessons, rehearsals and concerts is required. The school provides books and music, however the instruments are not provided.

## ParentVue

ParentVue is a secure, private website through Lincoln Public Schools that allows access to your child's real-time information. ParentVue allows you to track attendance, see class websites, view report cards and access Special Education documents. Please call to set up your ParentVue access today.

## School Messenger

School Messenger is a district-wide network used for communicating with parents. If there is a need for parents to get information immediately, I will send out a School Messenger. This may come to you via a phone call, an email, or through a text. You may designate which mode works best for your family.

## Student Materials

Lincoln Public Schools provides all of the materials students require for learning in the classroom. It is helpful for students to have a backpack to carry homework and other items to and from school. If you need assistance obtaining a backpack for your child, please contact us.

## Items From Home to School

Please leave play items and items that may distract from learning at home. Only school supplies, forms to be returned to school, and schoolwork should be brought to school.

## Textbook and Material Fines

It is the responsibility of each student to give proper care to instructional equipment, materials and supplies. Where carelessness leads to destruction or loss of equipment or materials beyond normal use, the student and parent should make appropriate payments.

## ELL (English Language Learners)

ELL services provide assistance to students with limited English skills to function in the regular English-speaking classroom, to develop proficiency in reading, writing, speaking, and listening in English, and to develop knowledge about the customs and culture of the school, community, and nation.

## Recess Temperature Guidance

<10\* temperature or wind chill = Inside Recess Rain/Snow = Inside Recess

# May 2026

## Lincoln Public Schools

SUNDAY	MONDAY	TUESDAY	WEDNESDAY	THURSDAY	FRIDAY	SATURDAY
					1	2
3	4	5	6	7 Cattle Bank	8	9
10	11	12	13	14 Cattle Bank	15	16
17	18	19	20	21 Last Day of School	22	23
24	25	26	27	28	29	30
31						

## » Important Dates

**May 7th**  
Cattle Bank

**May 14th**  
Cattle Bank

**May 21st**  
Last Day of School

*All procedures, guidelines and dates outlined in this document are subject to change, based on recommendations and directives issued by the Nebraska Department of Education, the Lincoln Lancaster County Health Department (LLCHD), or other governing body.*



## Before & After School Child Care for Roper Elementary School

Currently, Willard Community Center has a year-round licensed preschool, as well as before and after school programs for elementary school children.

This state licensed child care program is available from 6:30 a.m. until the beginning of the school day and resumes again right after school until 6:00 p.m.

The Roper school site offers a snack after school and a wide variety of activities, ranging from daily scheduled events to large group games to homework time.

Non-School day care is available at the Willard Community Center.

Contact Information below:

### **Willard Community Center**

Phone: 402-475-0805

1245 S Folsom St.

Lincoln, NE 68522

Monday-Friday

The office is open from 9 to 5.

## Food, Presents, Parties

### **LPS Elementary School Common Practices Document**

Due to food allergies/sensitivities and cultural considerations, no food may be brought for birthday parties, class rewards, or class parties. Party invitations are not allowed to be distributed at school or during school hours. Student birthdays and other celebrations or life events, will be recognized by teachers and classmates at school.

## Fund-A-Need

**FUND-A-NEED®**

Fund-A-Need is an award winning online program designed to help students and staff in Lincoln Public Schools. The program allows teachers and schools the avenue to post innovative educational ideas and classroom needs as a "proposal" for the community to view.

Proposals are approved by principals, submitted to the Foundation, and posted online. Donors may choose from the online list and make a tax-deductible donation to fund these classroom needs. Individuals who support a proposal will receive information about the activity from the teacher and students touched by the gift and a receipt from the Foundation as a record for the IRS.

**Log on to [www.foundationforLPS.org](http://www.foundationforLPS.org) or call 402-436-1612**



# June 2026

## Lincoln Public Schools

## » Important Dates

SUNDAY	MONDAY	TUESDAY	WEDNESDAY	THURSDAY	FRIDAY	SATURDAY
	1	2	3	4	5	6
7	8	9	10	11	12	13
14	15	16	17	18	19	20
21	22	23	24	25	26	27
28	29	30				

All procedures, guidelines and dates outlined in this document are subject to change, based on recommendations and directives issued by the Nebraska Department of Education, the Lincoln Lancaster County Health Department (LLCHD), or other governing body.



# 2025–2026 Lunch Schedule

GRADE	LUNCH/RECESS
Kindergarten	11:20 - 12:05
1st Grade	10:45 - 11:30
2nd Grade	11:55 - 12:40
3rd Grade	11:45 - 12:25
4th Grade	12:30 - 1:15
5th Grade	11:00 - 11:40

Some students will have lunch first then recess, others will have recess first then lunch. Lunch and Recess times are 20 minutes each.

## Meal Payment

It is still possible to maintain a balance in a student's individual account for an additional entree or milk only. Meal payments and balance notifications can be found in My School Bucks at: [home.LPS.org/ns/prices-payment](http://home.LPS.org/ns/prices-payment)

## Free/Reduced Lunch Applications

Families of students who may be eligible for free or reduced price school meals must submit a new application each new school year to determine eligibility. On-line application link can be found at: [home.LPS.org/ns/free-reduced](http://home.LPS.org/ns/free-reduced)



## Lunch Time Visitors

We ask for your patience as we continue to follow safe protocols for the lunchroom. All lunch time visitors will need to enter through Door 1. Please also be patient at the entrance desk. Our Secured Entrance Monitors may not recognize you the first couple of times you come. Please be cooperative as they check you in and be mindful that we prefer to be overly cautious about letting visitors in the building. Student safety is always our first priority.

- We do not have a lot of extra space available for visitors in the lunchroom. We will ask that you limit visitors to one family member at a time.
- If possible, we will have you sit next to your child at their assigned table in the lunchroom.
- If there is not enough room at your child's regularly assigned table, we will try to find another table nearby so that you can sit together.
- If you bring food from outside of the school, we may ask you to sit at separate table to insure the safety of children with food allergies. Please do not share food with other children.
- When the weather warms up, we have moved the picnic tables to the back of the building and you would be welcome to enjoy a picnic lunch with your child outside.



# July 2026

## Lincoln Public Schools

## » Important Dates

SUNDAY	MONDAY	TUESDAY	WEDNESDAY	THURSDAY	FRIDAY	SATURDAY
			1	2	3	4
5	6	7	8	9	10	11
12	13	14	15	16	17	18
19	20	21	22	23	24	25
26	27	28	29	30	31	

All procedures, guidelines and dates outlined in this document are subject to change, based on recommendations and directives issued by the Nebraska Department of Education, the Lincoln Lancaster County Health Department (LLCHD), or other governing body.

# Drop Off/Pick Up Traffic Maps

## Coddington Traffic Loop

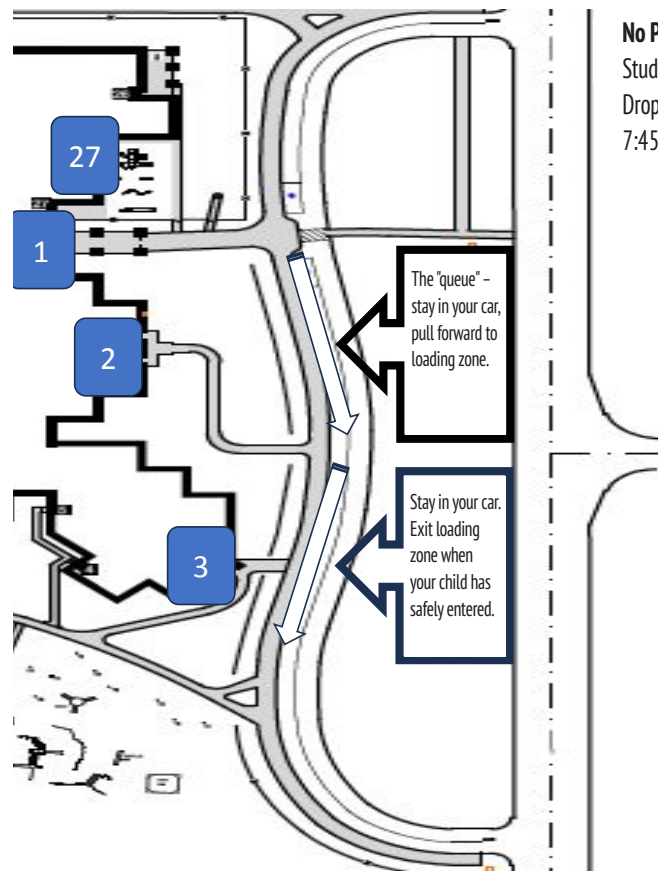

**No Parking**  
Student-Safe  
Drop Off/Pick Up and Go!  
7:45-8:15 and 2:45-3:15

### Student-Safe Drop Off/Pick Up and Go!

Stay in your vehicle. Always pull over to the curb before allowing your child to enter/exit the vehicle. Stay in line and advance in the "queue" until you get to the student-safe loading zone.

Limited parking is available on a first-come, first-serve basis outside of the student-safe zone. Do not block traffic in the lane.

## Parking Lot Traffic Loop

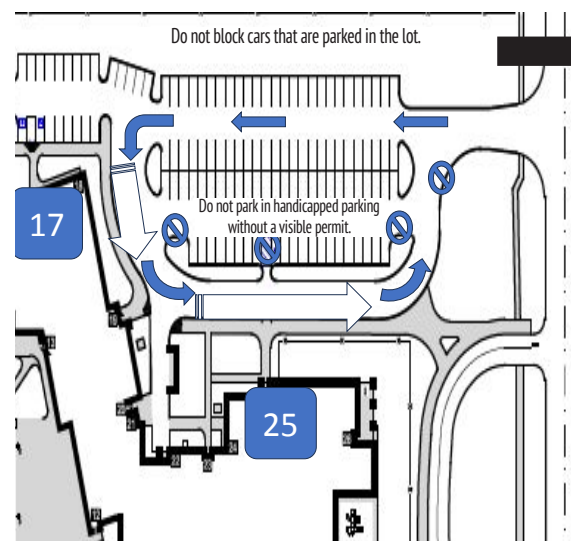

**No Parking**  
Reserved for LPS Buses and  
Day Care Vans

Student-Safe  
Drop Off/Pick Up and Go!  
7:45-8:15 and 2:45-3:15  
AFTER LPS Buses and Day  
Care Van Departure

**Student-Safe Drop Off/  
Pick Up and Go!**  
Stay in your vehicle. Always  
pull over to the curb before  
allowing your child to  
enter/exit the vehicle.

## West Traffic Loop

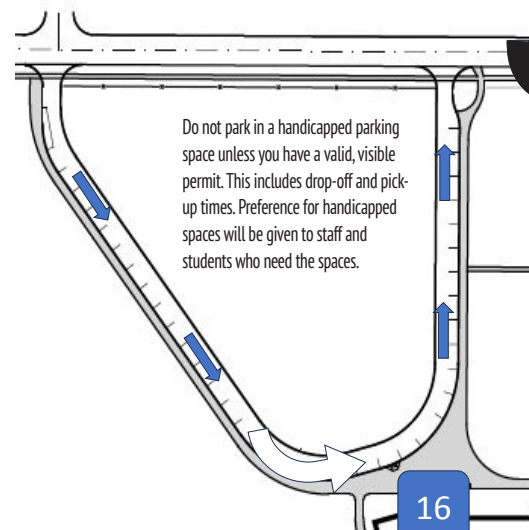

**No Parking** during  
Student-Safe Drop Off/Pick  
Up and Go! 7:45-8:15 and  
2:45-3:15

**Student-Safe Drop Off/  
Pick Up and Go!**  
Stay in your vehicle. Always  
pull over to the curb before  
allowing your child to  
enter/exit the vehicle.

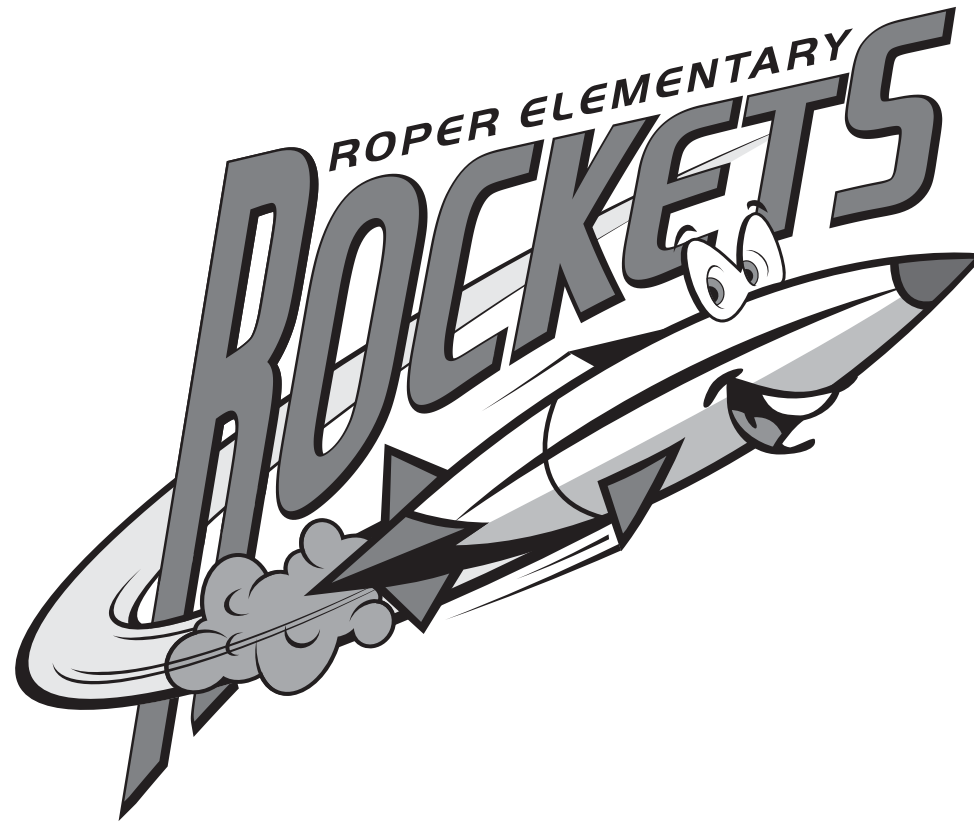

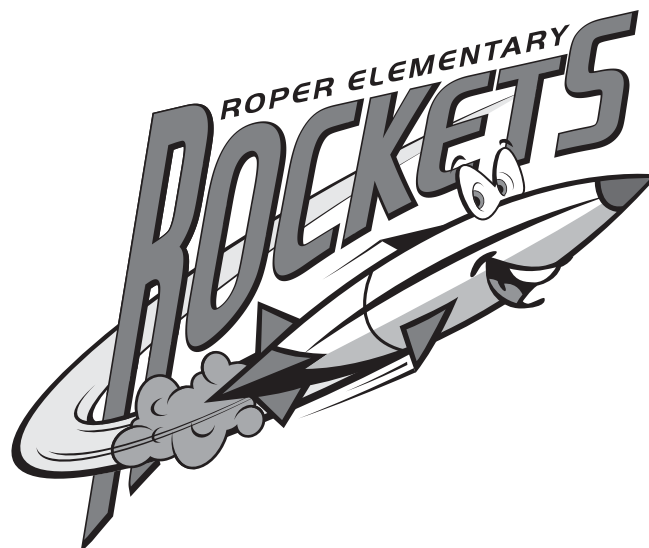

**LINCOLN BOARD OF EDUCATION** 5905 O Street • Lincoln, NE 68510



Barbara Baier  
John Goodwin

Marilyn Johnson-Farr  
Mara Krivohlavek  
Annie Mumgaard

Bob Rauner  
Piyush Srivastav

John Skretta, Interim Superintendent

5/25

The Lincoln Public School District does not discriminate on the basis of race, color, national origin, religion, sex, marital status, sexual orientation, disability, age, pregnancy, childbirth or related medical condition, genetic information, citizenship status or economic status in its programs, activities and employment.